

Gole Road Pirbright, GU24 0PZ



£450,000 Freehold



- Land measuring approximately 2.86 acres
- Electricity connected
- Fenced into 6 x separate sections
- Located within the Green Belt

- Running water & mains drainage
- No onward chain
- Located between Brookwood & Pirbright



Registered Office: 13 Claremont Avenue, Camberley, GU15 2DR
Registered No. 8078018 England and Wales

Luffandwilkin.co.uk
info@luffandwilkin.co.uk
Tel 01252 838 899

1 Guildford Road, Frimley Green, Surrey, GU16 6NL

Summary

An ideal opportunity to acquire land measuring approximately 2.86 acres with the added benefit of running water, mains drainage and connection to electricity. The land is currently divided into 6 x separate sections and is available as a freehold purchase with no onward chain.

Location: The land is located between Pirbright and Brookwood, providing access to local schools, amenities and transport links. Pirbright village is also within close proximity and boasts the cricket pavilion, pubs and a picturesque pond.

For further information or to view, please call:

Land & New Homes Department - 01252 838899

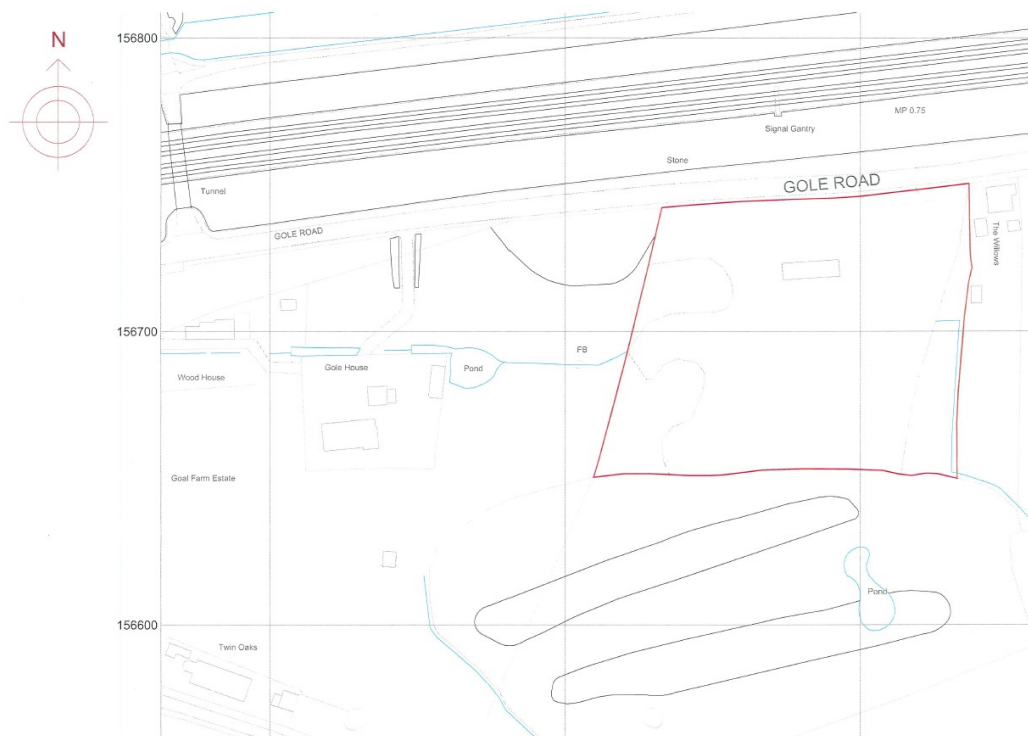

These particulars have been produced in good faith and are believed to be materially correct and fair, though their accuracy is not guaranteed and not intended to form part of any contract. None of the appliances or devices have been tested by Luff & Wilkin Property Specialists Ltd and no warranty is given or implied as to their working order.